



**KOMA**  
**VK56**  
**VK78**

**OWNERS MANUAL**

**Changing from left hand retrieve to right hand retrieve.**

1. Release the brake **VERY IMPORTANT**
2. With the point of a small screwdriver in one of the slots in (20) the E-clip, you lever it gently to the side.
3. Pull out (19) the one way bearing – turn it over and put it back again
4. Push (20) the E-clip in place again. You just place it in position to the groove in the main shaft and push it in position again. You can use the screwdriver for this.

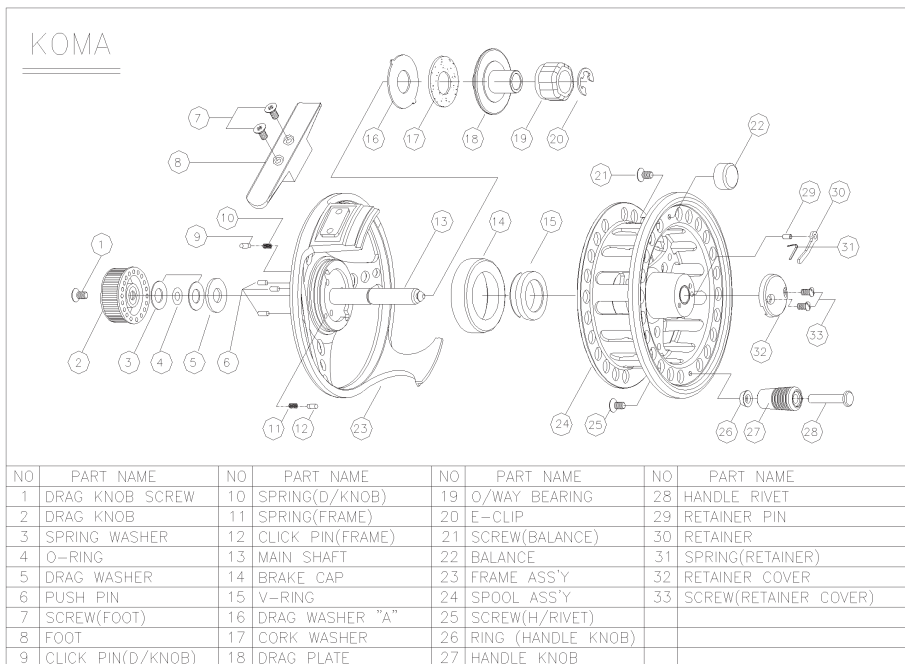

NO	PART NAME	NO	PART NAME	NO	PART NAME	NO	PART NAME
1	DRAG KNOB SCREW	10	SPRING(D/KNOB)	19	O/WAY BEARING	28	HANDLE RIVET
2	DRAG KNOB	11	SPRING(FRAME)	20	E-CLIP	29	RETAINER PIN
3	SPRING WASHER	12	CLICK PIN(FRAME)	21	SCREW(BALANCE)	30	RETAINER
4	O-RING	13	MAIN SHAFT	22	BALANCE	31	SPRING(RETAINER)
5	DRAG WASHER	14	BRAKE CAP	23	FRAME ASS'Y	32	RETAINER COVER
6	PUSH PIN	15	V-RING	24	SPOOL ASS'Y	33	SCREW(RETAINER COVER)
7	SCREW(FOOT)	16	DRAG WASHER "A"	25	SCREW(H/RIVET)		
8	FOOT	17	CORK WASHER	26	RING (HANDLE KNOB)		
9	CLICK PIN(D/KNOB)	18	DRAG PLATE	27	HANDLE KNOB		

Vision Group Ltd  
Niinistökatu 1  
05800 Hyvinkää  
Finland  
358 (0)9 2797 610  
service@visiongroup.fi

For service centers visit:  
[www.visionflyfishing.com](http://www.visionflyfishing.com)